

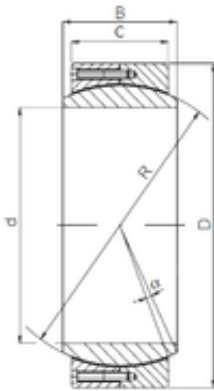

AMERICAN Timken BEARING MFG.CORP.

480 mm x 650 mm x 230 mm ISO GE 480 QCR
plain bearings



Bearing No. GE 480 QCR

Size	480x650x230 mm
Bore Diameter	480 mm
Outer Diameter	650 mm
Width	230 mm
d	480 mm
D	650 mm
B	230 mm
C	195 mm
R	565 mm
Angle	3,8 °

GE 480 QCR Bearing 2D drawings and 3D CAD models