

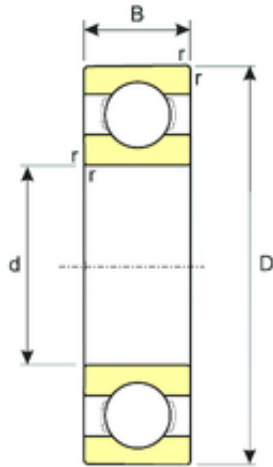

# AMERICAN Timken BEARING MFG.CORP.



3 mm x 7 mm x 2 mm ISB 683 deep groove ball bearings

Bearing No. 683

Size	3x7x2 mm
Bore Diameter	3 mm
Outer Diameter	7 mm
Width	2 mm
d	3 mm
D	7 mm
B	2 mm
C	2 mm
r min.	0,15 mm
Basic dynamic load rating (C)	0,24 kN

683 Bearing 2D drawings and 3D CAD models