

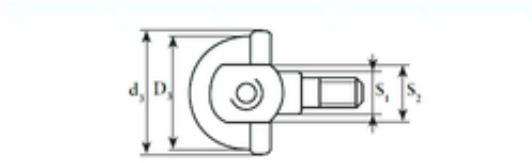

AMERICAN Timken BEARING MFG.CORP.

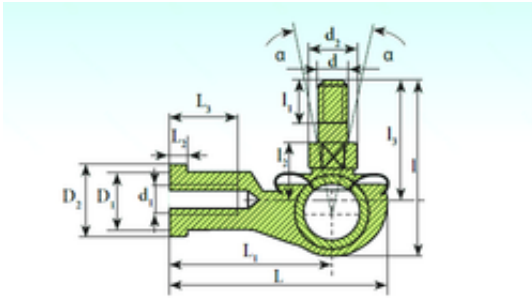

SQ 12 C RS Bearing 2D drawings and 3D CAD models

ISB SQ 12 C RS plain bearings

Bearing No. SQ 12 C RS

d	12 mm
S1	15 mm
L2	6,5 mm
L3	25 mm
l	57,5 mm
d2	17 mm
d3	32 mm
l1 min.	17 mm
l2 max.	19 mm
l3 min.	42 mm
D1	17,5 mm
D2	22 mm
D3	31 mm
L	66 mm
L1	50 mm
S2	19 mm
Thread (G)	M12x1,25
Angle	25 °
Weight	0,164 Kg
Basic dynamic load rating (C)	11 kN