

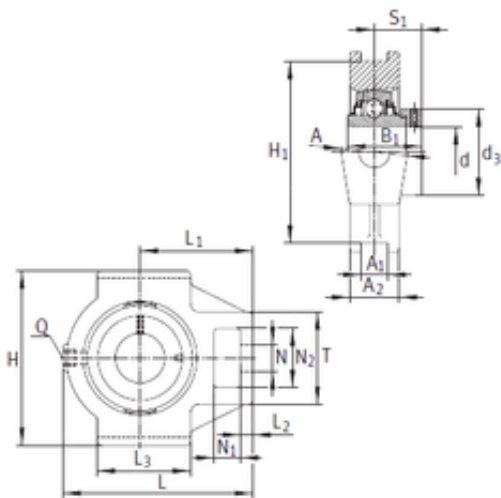

AMERICAN Timken BEARING MFG.CORP.

INA RTUE90 bearing units

Bearing No. RTUE90



RTUE90 Bearing 2D drawings and 3D CAD models

Bore Diameter	90 mm
d	90 mm
S1	46,5 mm
Thread (Q)	Rp1/8
L2	30 mm
L3	140 mm
d3	118 mm
A	80 mm
A1	28 mm
B1	69,5 mm
H	215 mm
H1	190 mm
L	275 mm
L1	170 mm
N	47 mm
N1	40 mm
T	130 mm
A2	55 mm
N2	80 mm
Weight	11,87 Kg
Basic dynamic load rating (C)	96 kN
Category	Take Up Unit Bearings
Inventory	0.0
Manufacturer Name	SCHAEFFLER GROUP
Minimum Buy Quantity	N/A
Weight / Kilogram	13.891



AMERICAN Timken BEARING MFG.CORP.

EAN	4012802795066
Product Group	M06110
Component Description	Take Up Bearing Only
Rolling Element	Ball Bearing
Housing Style	Unit Only
Mounting Method	Eccentric Collar
Compatible Take Up Frame	Not Specified
Adjustment Travel Length	0
Insert Part Number	GE90KRRB
Housing Material	Cast Iron
Other Features	Single Row Spherical Double Land Riding Rubber Contact Seal
Inch - Metric	Metric
Long Description	Take Up Bearing Only; 90MM Bore; 28MM Slot Width; 190MM Slot to Slot Distance; Ball Bearing; Unit Only; Eccentric Collar Mount; GE90KRRB Insert Part; Cast Iron Housing Material
Category	Take Up Units
UNSPSC	31171533
Harmonized Tariff Code	8483.20.40.40
Noun	Bearing
Keyword String	Take Up
Manufacturer URL	http://www.ina.com
Weight / LBS	26.169
Slot Width	1.102 Inch 28 Millimeter
Bore	3.543 Inch 90 Millimeter
Slot to Slot Distance	7.48 Inch 190 Millimeter