

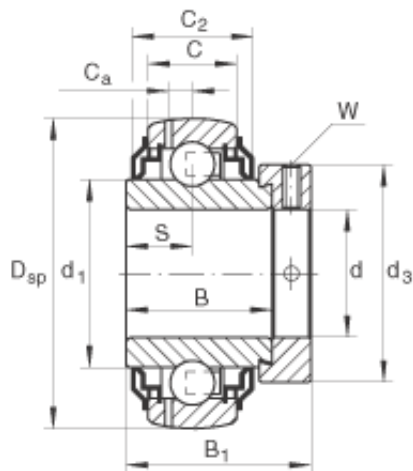

AMERICAN Timken BEARING MFG.CORP.



INA GE35-KRR-B-2C deep groove ball bearings

Bearing No. GE35-KRR-B-2C

GE35-KRR-B-2C Bearing 2D drawings and 3D CAD models

Size	35x72x51.3 mm
Bore Diameter	35 mm
Outer Diameter	72 mm
Width	51,3 mm
d	35 mm
D _{SP}	72 mm
B ₁	51,3 mm
B	37,7 mm
C	19 mm
C ₂	29,2 mm
C _a	5,6 mm
d ₁	46,8 mm
d _{3 max}	51 mm
S	18,8 mm
W	5 mm
m	0,58 kg / Weight
C _r	27500 N / Dynamic load rating (radial)
C _{0r}	15300 N / Static load rating (radial)
Category	Bearings
Inventory	0.0
Manufacturer Name	SCHAEFFLER GROUP
Minimum Buy Quantity	N/A
Weight / Kilogram	0.58



AMERICAN Timken BEARING MFG.CORP.

Product Group	
---------------	--

	B04264
--	--------